

DESIGNED BY: _____
 CHECKED BY: _____
 DRAFTED BY: _____

SCALE: _____
 LAYOUT: _____

DATE: _____ TIME: _____

DRAWING LOCATION: _____

© 2008 S&B Engineering, Inc. All rights reserved. AUG 08 2008 11:25:50 (YOUR INITIALS)

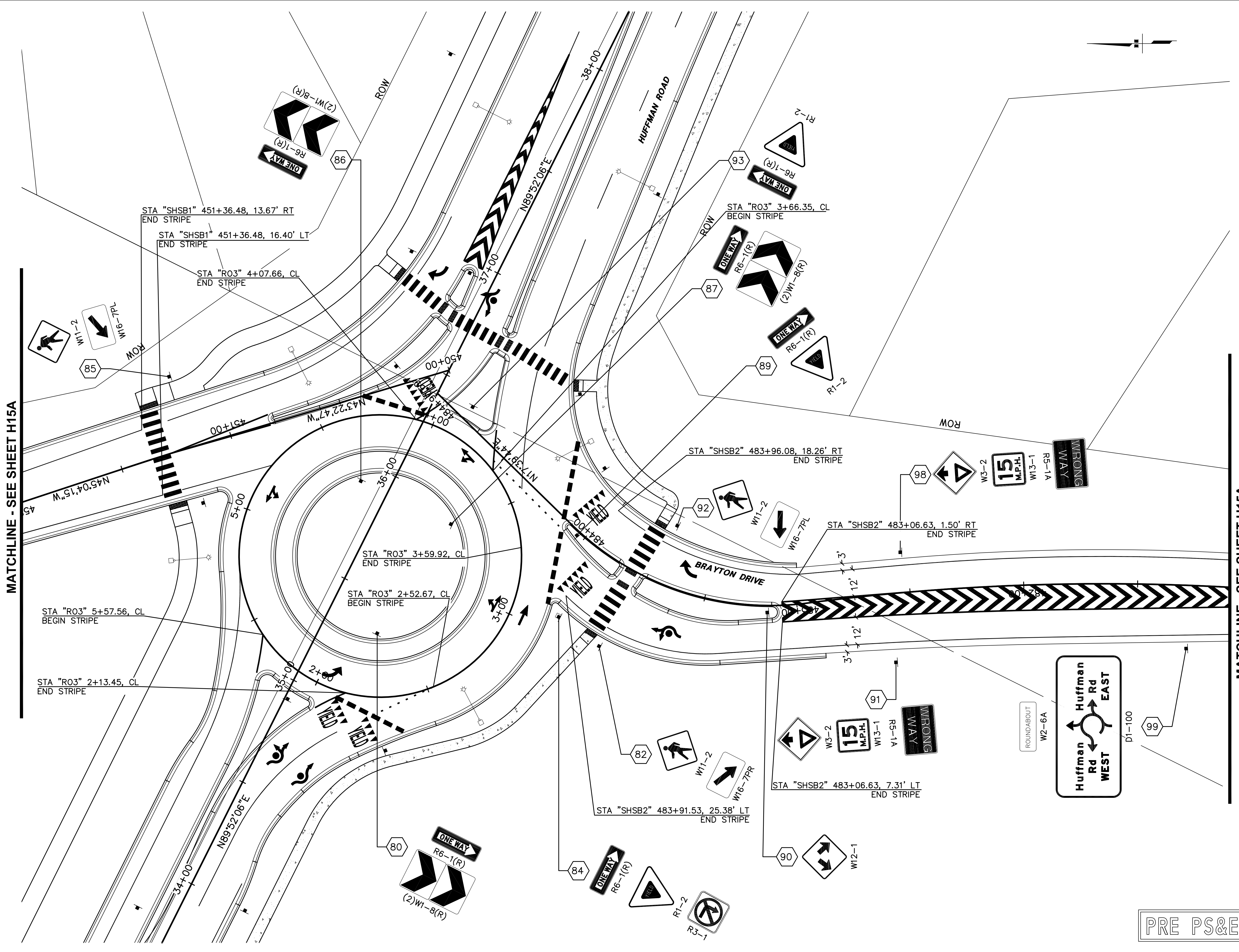

SHEET NO.	TOTAL SHEETS	
H15	59	
STATE	YEAR	
ALASKA	2008	
PROJECT DESIGNATION		
STP-0534(1)/53933		
ADDENDUM NO.		
ATTACHMENT NO.		
REVISIONS		
NO.	DATE	DESCRIPTION

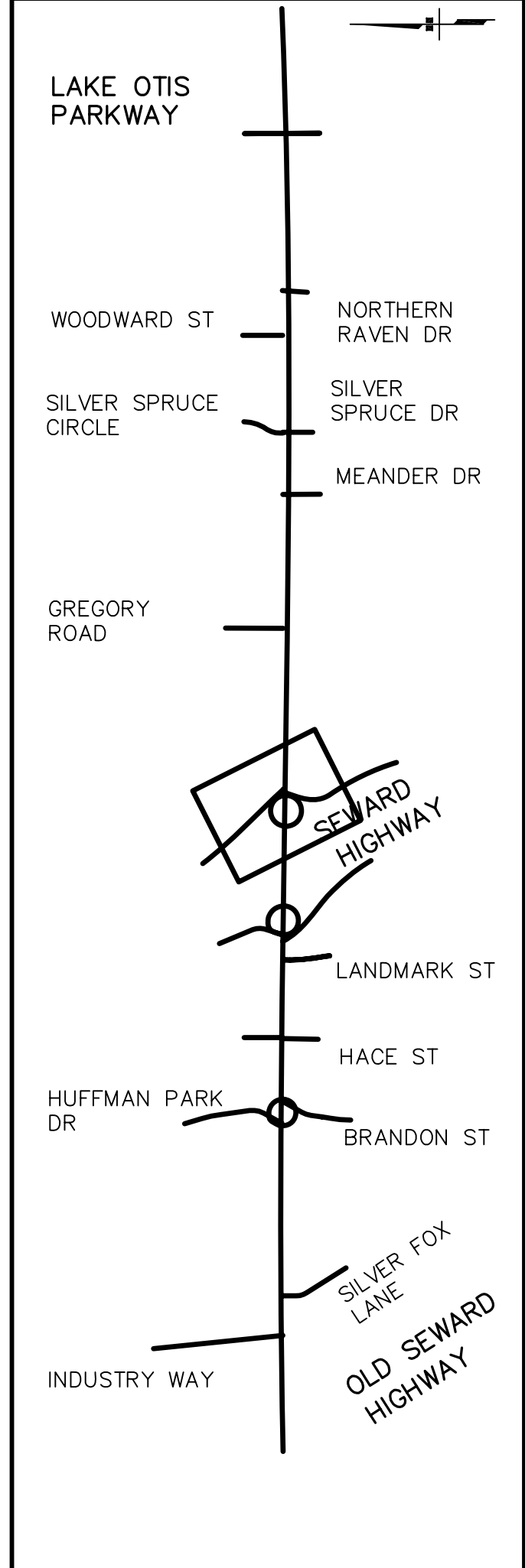

STATE OF ALASKA
 49th
 Steven K. Noble
 CE-10051
 REGISTERED PROFESSIONAL ENGINEER

PLANS DEVELOPED BY: DOWL ENGINEERS

STATE OF ALASKA
 DEPARTMENT OF TRANSPORTATION
 AND PUBLIC FACILITIES

**HUFFMAN ROAD
 RECONSTRUCTION
 SIGNING, STRIPING,
 AND ILLUMINATION**

SEWARD HIGHWAY-
 EAST RAMPS

PRE PS&E